

# Blowing Block BlowLite

Seitz PET Blowing Block BlowLite is designed for most economic production of small bottles.



## Blowing Block BlowLite

### Technical data

<b>Function</b>	P1: 2/2-way NC with integrated check valve P2: 2/2-way NC EXH: 2/2-way NO
<b>Operating pressure</b>	2 ... 40 bar
<b>Pilot pressure</b>	7.0 bar +0/-0.5 bar
<b>Orifice diameter</b>	Pre-blow P1: Ø 12mm Finish-blow P2: Ø 12mm Exhaust EXH: Ø 14 mm
<b>P1 Flow Control</b>	Included 3 positions: Ø 2.5/4/6mm
<b>Port sizes</b>	Pilot air supply PP: G 1/8" female Pre-blow P1: Ø 12mm Finish-blow P2: Ø 12mm Exhaust EXH: G 1" Cavity (Out): Ø 14mm
<b>Material</b>	Block body: Aluminium coated Pistons: Plastic, FDA compliant Grease: FDA compliant
<b>Mounting</b>	Any position
<b>Media</b>	Compressed air according to ISO 8573-1 – Particles: Class 2 – Pressure dew point: Class 4 – Oil content: Class 2
<b>Media temperature</b>	+5°C ... +40°C
<b>Ambient temperature</b>	+10°C ... +50°C
<b>Pilot valves</b>	24V DC, 2.5 W, IP65 Without manual override Female connectors not included

## Performance data

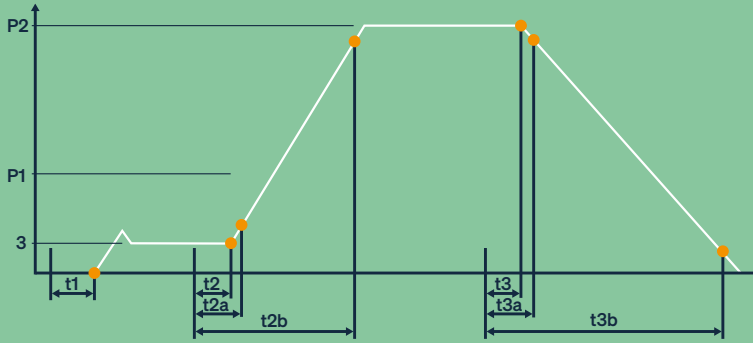

Bottle size in liter	0.5	1.0	1.5
Pilot pressure PP in bar	6.5	6.5	6.5
Pre-blow supply pressure P1 in bar	10	10	10
Finish-blow supply pressure P2 in bar	36	36	36
<b>t1:</b> Time in ms from P1 signal to start of pressure rise	32	32	32
<b>t2:</b> Time in ms from P2 signal to start of pressure rise	12	12	12
<b>t2a:</b> Time in ms from P2 signal to pressure 6.6 bar (10% of P2)	26	31	35
<b>t2b:</b> Time in ms from P2 signal to pressure 32.7 bar (90% of P2)	64	99	135
<b>t3:</b> Time in ms from EXH signal to start of pressure drop	27	27	27
<b>t3a:</b> Time in ms from EXH signal to pressure 32.4 bar (90% of EXH)	30	33	35
<b>t3b:</b> Time in ms from EXH signal to pressure 3.6 bar (10% of EXH)	104	167	231

Above data vary depending on piping, stability of air supply and silencer performance.

## Order information

Part no.	Denomination	Gross-Weight
288.046.00	Blowing Block BlowLite	1.1 kg/pc (net weight 1.0 kg/pc)

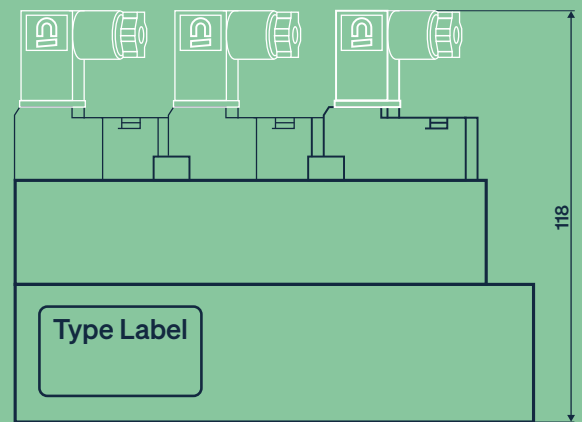
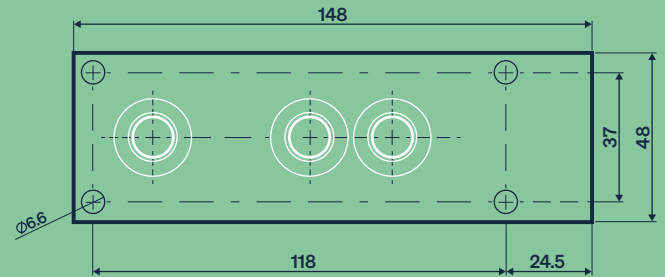

For detailed dimensional drawing or 3-D model, please contact us.

**Eugen Seitz AG**  
Spitalstrasse 204  
8623 Wetzikon  
Switzerland  
**+41 44 931 80 80**  
[info@seitz.ch](mailto:info@seitz.ch)

**Seitz Valve Technology (Shanghai) Co., Ltd.**  
Room 910, Building No 67  
Hong Cao Rd 421  
200233 Shanghai  
People's Republic of China  
**+86 21 3363 3880**  
[information@seitz.cn](mailto:information@seitz.cn)